

STAINLESS STEEL FLEXIBLE CONNECTOR

COMPLY WITH AS/NZS 3499:1997
 AS/NZS 3707:2001
 AS/NZS 4020:2005
 ASTM E1086:2014
 SS 375:2015

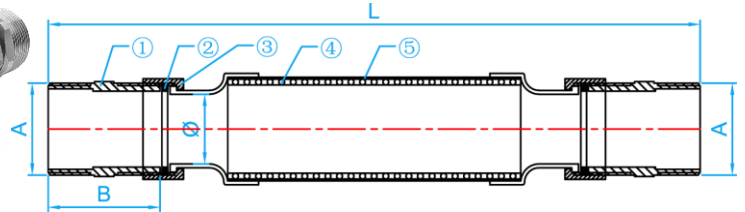

SECTION VIEW

STANDARD SPECIFICATIONS

Working Pressure	20 bars
Suitable Temperature	-20°C~120°C

COMPONENT PARTS

ITEM	PARTS	MATERIAL
1.	Nipple	AISI304
2.	Washer	PTFE
3.	Nut	AISI304
4.	Inner Tube	AISI304
5.	Body	AISI304

DIMENSIONS

SKU	A (inch)	B (mm)	Ø (mm)	L (mm)	WEIGHT (kg)	PCS/CTN
FTN25300	1" BSPT	40	22	310	0.585	20
FTN35300	1 ¼" BSPT	44	28	310	0.910	10
FTN42300	1 ½" BPST	45	35	310	1.110	10
FTN50300	2" BSPT	50	47	310	1.420	10