

STAINLESS STEEL 316L PRESS FIT FITTINGS (M PROFILE)

COMPLY WITH BSEN1254-2: 1998

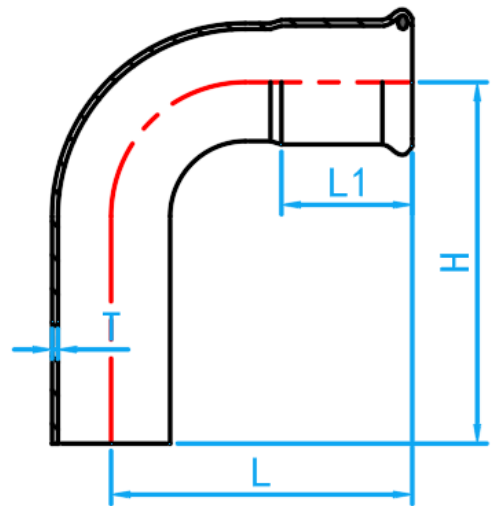

MXF 90° ELBOW



CROSS SECTIONAL VIEW

DIMENSIONS

| SKU | SIZE (mm) | L (mm) | L1 (mm) | H (mm) | T (mm) | WEIGHT (kg) | PCS/CTN |
|-------------------|-----------|--------|---------|--------|--------|-------------|---------|
| SS316LPFNE90015MF | 15 | 42 | 20 | 44 | 1.5 | 0.042 | 360 |
| SS316LPFNE90020MF | 22 | 51 | 21 | 55 | 1.5 | 0.093 | 150 |
| SS316LPFNE90025MF | 28 | 60 | 23 | 68 | 1.5 | 0.131 | 160 |
| SS316LPFNE90035MF | 35 | 72 | 26 | 89 | 1.5 | 0.212 | 100 |
| SS316LPFNE90042MF | 42 | 85 | 31 | 95 | 1.5 | 0.268 | 60 |
| SS316LPFNE90050MF | 54 | 105 | 36 | 113 | 1.5 | 0.415 | 30 |
| SS316LPFNE90065MF | 67 | 140 | 50 | 150 | 1.8 | 0.800 | 15 |
| SS316LPFNE90080MF | 76 | 150 | 51 | 182 | 2.0 | 1.026 | 12 |
| SS316LPFNE90100MF | 108 | 221 | 75 | 238 | 2.0 | 2.206 | 4 |