

# STAINLESS STEEL FLUID SOLENOID VALVE (ENERGY SAVING NORMALLY CLOSED IP65)

COMPLY WITH BS5154:1991  
AS/NZS4020:2005

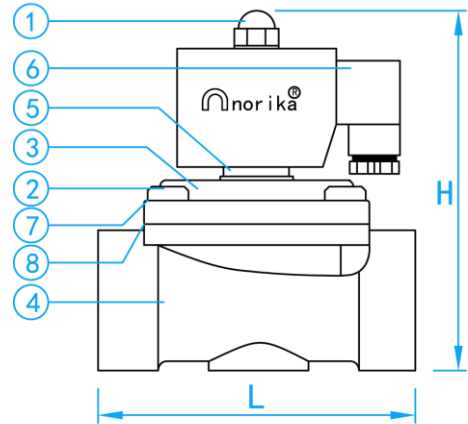

FRONT VIEW

Is an energy saving solenoid valve, with low power consumption and will not overheat. Constantly supplies water and in the occurrence of the power is turned off or power failure water supply will be automatically shutoff.

## STANDARD SPECIFICATIONS

Nominal Pressure	0-10 Bar
Voltage Rating	AC: 24-220V DC: 24-220V
Power	15 ~ 25mm Starting Power: 30 W Steady Power: 5 W
	35 ~ 50mm Starting Power: 40 W Steady Power: 7 W
Operating Temperature	-20°C ~ 80°C
Waterproof Grade	IP65

## DIMENSIONS

SKU	SIZE (mm)	L (mm)	W (mm)	H (mm)	WEIGHT (kg)	PCS/CTN
SVSSN015IP65ES	15	68	27	110	0.81	25
SVSSN020IP65ES	20	71	32	117	0.89	25
SVSSN025IP65ES	25	98	39.5	125	1.05	25
SVSSN035IP65ES	35	115	47	160	2.4	10
SVSSN042IP65ES	42	122	58	170	2.52	10
SVSSN050IP65ES	50	166	70.5	192	4.3	6

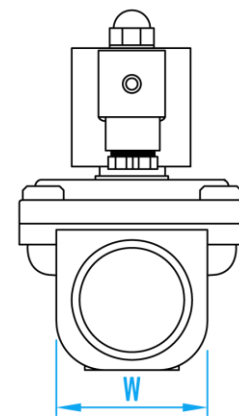

SIDE VIEW

## COMPONENT PARTS

ITEM	PARTS	MATERIAL
1.	Nut & Washer	AISI304
2.	Bolt	AISI304
3.	Valve Bonnet	AISI304
4.	Valve Body	AISI304
5.	Spring Plunger	AISI304
6.	DIN Box	BMC
7.	O-Ring	EPDM
8.	Diaphragm	EPDM